



DY50-112/5T \times 1.5-M24 \times 2

Agricultural machinery bearings

IL50-112/5T \times 1.5-
M24 \times 2

技术信息

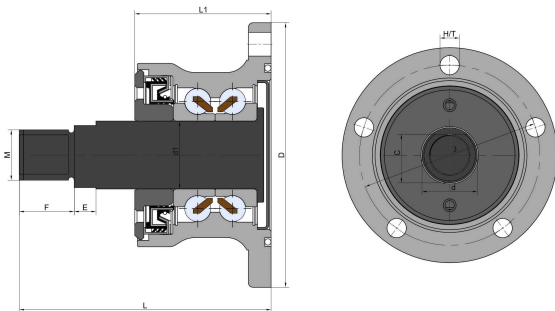

主要尺寸和性能参数

| | | |
|-------------|-----------------------------|--------------------------------|
| J | 登录可见尺寸，去登录 | Pitch circle diameter |
| D | 145mm | Outside diameter |
| H/T | 5 \times M12 \times 1.5 | Hole/Thread |
| d1 | 30mm | Bore diameter |
| C | 28mm | D-shape hole cut out dimension |
| M | M24 \times 2 | Outer Thread |
| L | 106mm | Total length |
| L1 | 60mm | Total flange length |
| E | 18mm | Length of D shape |
| F | 28mm | Length of threaded part |
| \approx m | 2.99Kg | weight |
| Cor | 60Kn | Radial dynamic load rating |
| Cr | 45.8Kn | Radial static load rating |
| Pu | 1.924Kn | Fatigue load limit |

*数据表仅为所选产品的尺寸和基本额定载荷概览。请始终遵守本产品的所有更多信息和指南。您可通过我们网站上的联系表了解更多信息。